

INNOVATION LEADS TO VALUE



SWE 08F MINI EXCAVATOR

◆ Total weight: 1.01 t

◆ Engine power: 7.2 kW / 2 400 rpm

◆ Bucket capacity: 0.022 m³



- ◆ Equipped with high-performance engine, meeting Euro 5 emission standard, and low noise and shaking.
- ◆ Equipped with famous brand hydraulic components that are reliable and durable. Pilot hydraulic maneuvering is used for precise and smooth operation.
- ◆ Tail cover with large opening angle and front sealing plate that can be fully opened to facilitate easy day-to-day maintenance.
- ◆ With the chassis expansion and contraction, moving arm deflection, upper trolley rotation, bulldozer folding and other functions, it can be used for the works in narrow spaces.
- ◆ Various manipulator handles are centrally arranged for flexible switching of functions, and flip armrest box and pilot safety switch are installed for safe and comfortable operation.



Parameters and performance of the main machine

Dimension (L×W×H)		mm	2 640 x 750 x 2 275
Overall weight	With rubber track	t	1.01
	With steel track	t	/
Standard bucket capacity		m ³	0.022
Bucket digging force		kN	9.4
Arm digging force		kN	5.8
Max. drawbar pull		kN	8.3
Travel speed (Max/Min)		km/h	2.9 / 1.5
Gradeability		%	57
Ground pressure		kPa	24.5
Slewing speed		rpm	8.2
Engine	Brand		YANMAR
	Model		2TNV70-PSU(Euro V)
	Max. torque	N.m/rpm	34.4 / 1 800
	Displacement	L	0.57
	Power/Rotation speed	kw/rpm	7.2 / 2 400
Fuel tank capacity		L	10
Primary pump	Type		Quantitative gear pump
	Flow rate	L/min	9.6+9.6
Pressure of main relief valve		MPa	16
Hydraulic oil tank capacity		L	9.5

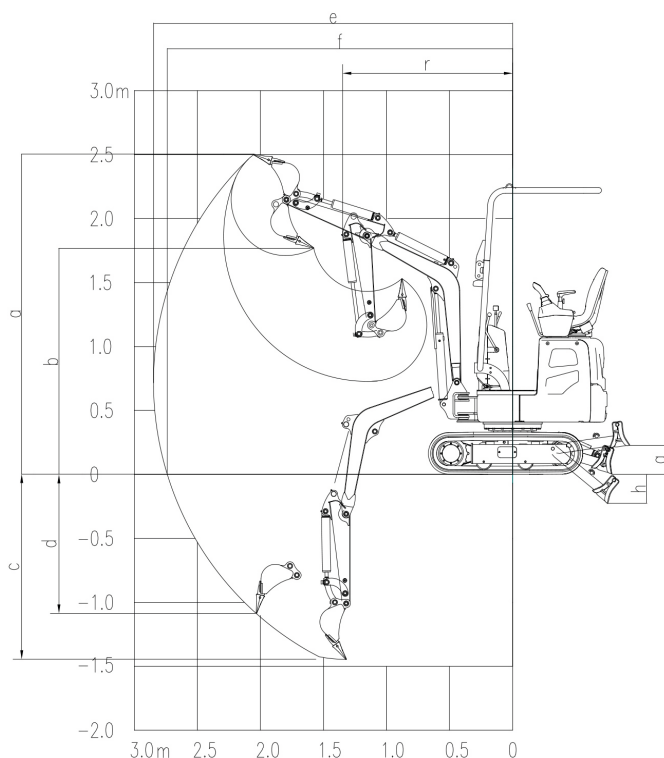

Working range

	Boom length	mm	1 350
	Arm length	mm	700
a	Max. digging height	mm	2 505
b	Max. dumping height	mm	1 770
c	Max. digging depth	mm	1 450
d	Max. vertical digging depth	mm	1 085
e	Max. digging reach	mm	2 850
f	Max. digging reach at ground level	mm	2 740
g	Max. lift height of the dozer blade	mm	225
h	Max. digging depth of dozer blade	mm	225
r	Min. swing radius	mm	1 350

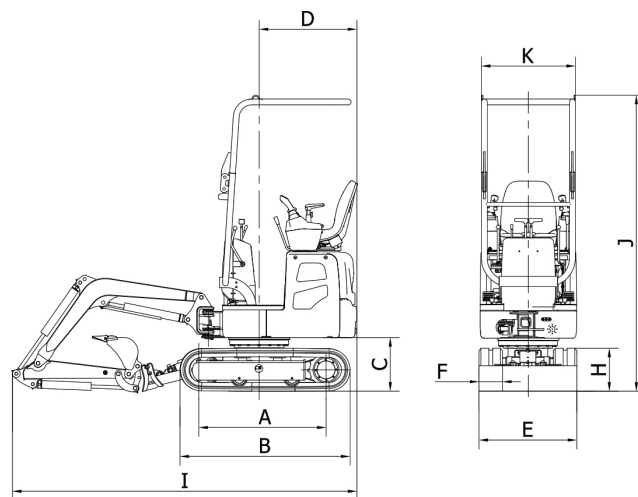

Outline dimensions

A	Length to center of rollers	mm	975	G	Chassis ground clearance	mm	130
B	Total track length	mm	1 300	H	Track height	mm	330
C	Counterweight clearance	mm	420	I	Total length	mm	2 640
D	Platform tail slewing radius	mm	750	J	Max. height of cab	mm	2 275
E	Track width	mm	750 / 1 000	K	Uppercarriage width	mm	740
F	Track shoe width	mm	180				

◆ The above parameters may be different due to product upgrading.

